

Receptacle, press-fitment
solder pot
RC3SP



Test Probes &
Interfacing Components

Telephone: +44 (0)1787 478678

sales@coda-systems.co.uk

technical@coda-systems.co.uk

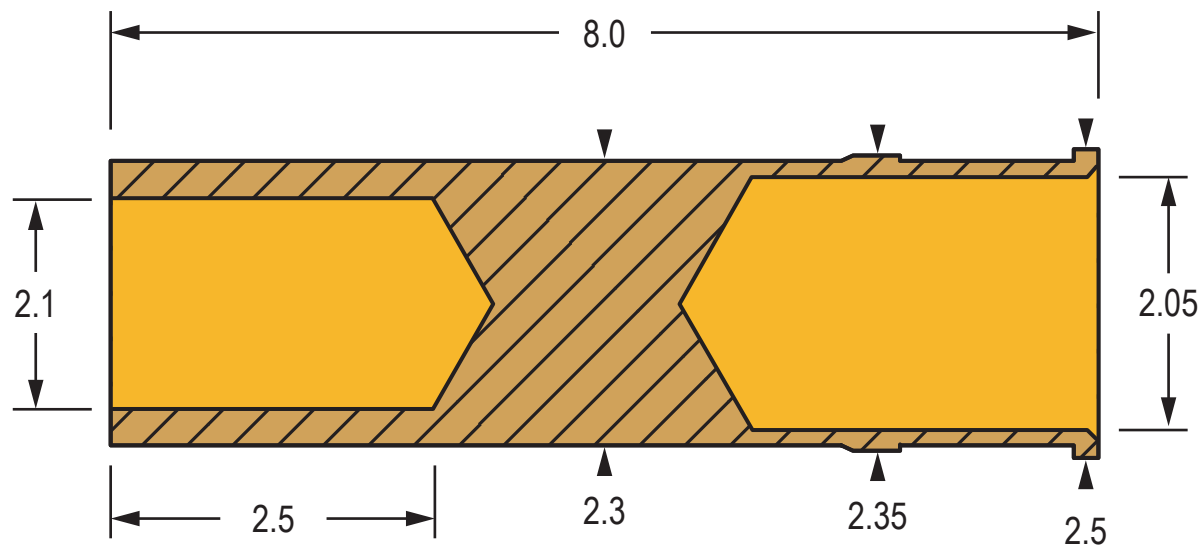

Specifications

Materials

Brass C3604

Plating

Gold plating over nickel

Installation

- Recommend solder wire to solder pot pre-insertion
- Mounting hole size, soft material: 2.28mm
- Mounting hole size, hard material: 2.29mm
- Mounting hole size, epoxy or solder in: 2.30mm

PART NUMBER RC4SP		THE INFORMATION CONTAINED IN THIS DRAWING IS THE PROPERTY OF © CODA SYSTEMS LTD. NOT TO BE COPIED OR DISCLOSED TO A THIRD PARTY WITHOUT THE PRIOR, WRITTEN CONSENT OF CODA SYSTEMS LTD.	
SIZE A4	SCALE NTS	DRAWN IN ACCORDANCE WITH ISO STANDARDS	UNLESS OTHERWISE SPECIFIED 1. DIMENSIONS ARE IN MM 2. DIMENSIONAL LIMITS APPLY AFTER PLATING / COATING 3. REMOVE ALL BURRS AND BREAK EDGES .25 MAX 4. MACHINE FILLET RADIUS .25 MAX 5. MACHINED SURFACES FLAT WITHING 0.08 mm/mm 6. NON-MACHINED SURFACES FLAT WITHIN 0.25 mm/mm 7. DIAMETERS ON COMMON CL TO BE CONCENTRIC WITHIN 0.13 8. PERPENDICULAR SURFACES TO BE SQUARE WITHIN .13 mm/mm 9. REFERENCE () DIMENSIONS HAVE NO TOLERANCES
RoHS Compliant? <input checked="" type="checkbox"/>		DATE 27/01/2025	
		VERSION A1	