



SD-MINI-4-SC-PRO
spring loaded, docking
connectors for handheld
devices and docking stations.



**Test Probes &
Interfacing Components**

Telephone: +44 (0)1787 478678 | sales@coda-systems.co.uk | technical@coda-systems.co.uk

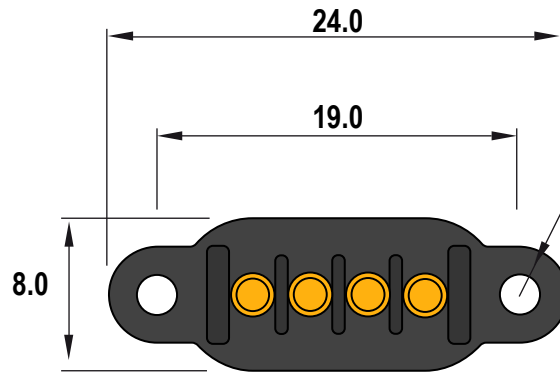
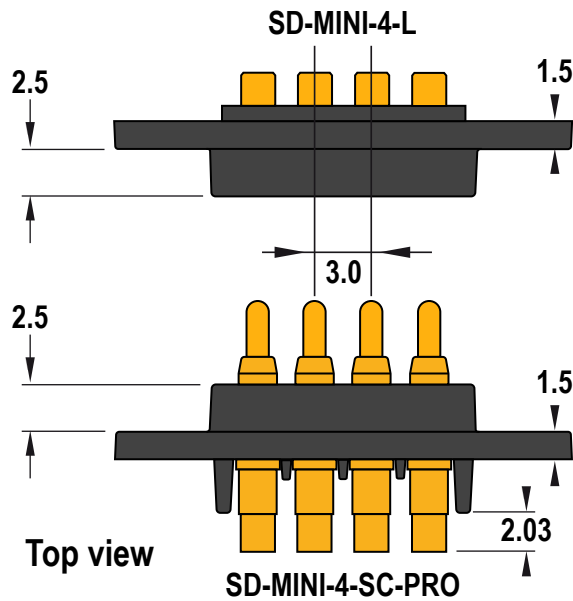

**Spring contact
back view**

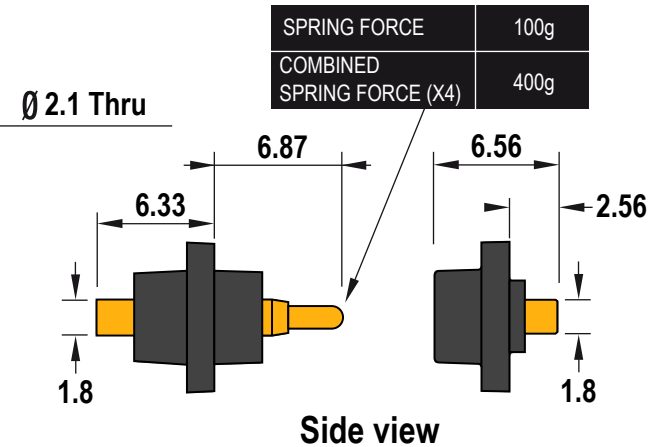

Side view

Spring contact: HD-PD14JST
Contact land: IPPS2S
Ideal compression of HD-PD14JST: 2.05mm

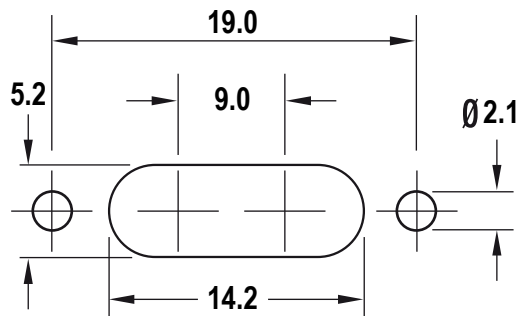

Panel cut-out dimensions

PART NUMBER SD-MINI-4-SC-PRO & SD-MINI-4-L				THE INFORMATION CONTAINED IN THIS DRAWING IS THE PROPERTY OF © CODA SYSTEMS LTD. NOT TO BE COPIED OR DISCLOSED TO A THIRD PARTY WITHOUT THE PRIOR, WRITTEN CONSENT OF CODA SYSTEMS LTD.	
SIZE A4	SCALE NTS	PLASTIC TYPE POLYAMIDE PA66	VERSION A	TOLERANCES LINEAR .x = ± 0.2mm .xx = ± 0.10mm .xxx = ± 0.025mm	
RoHS Compliant? <input checked="" type="checkbox"/>				SURFACE ANGULAR ± 1°	
ENGINEER G. D		CHECKED BY H. D		DATE 23/07/24	DRAWN IN ACCORDANCE WITH ISO STANDARDS
UNLESS OTHERWISE SPECIFIED 1. DIMENSIONS ARE IN MM 2. DIMENSIONAL LIMITS APPLY AFTER PLATING / COATING 3. REMOVE ALL BURRS AND BREAK EDGES .25 MAX 4. MACHINE FILLET RADIUS .25 MAX 5. MACHINED SURFACES FLAT WITHIN 0.08 mm/mm 6. NON-MACHINED SURFACES FLAT WITHIN 0.25 mm/mm 7. DIAMETERS ON COMMON CL TO BE CONCENTRIC WITHIN 0.13 8. PERPENDICULAR SURFACES TO BE SQUARE WITHIN .13 mm/mm 9. REFERENCE () DIMENSIONS HAVE NO TOLERANCES					