

KWP100F KELVIN PIN

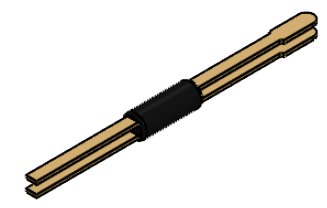
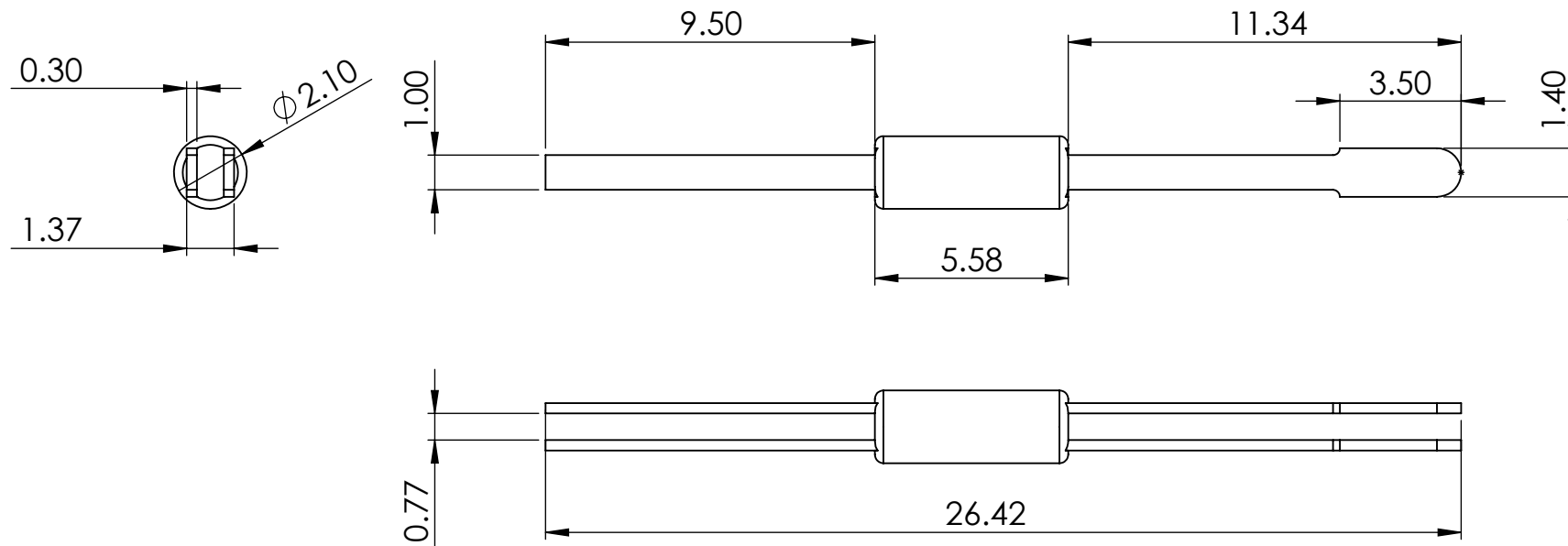

<b>Material:</b> <b>Pin: Beryllium copper alloy/Gold plated</b> <b>Insulator: Nylon6/6</b>		This drawing and any information or descriptive material set out on it are the confidential and copyright property of Coda Systems Ltd. © and MUST NOT BE DISCLOSED, COPIED, LOANED in whole or part or used for any purpose without the written permission of Coda Systems Ltd.		<b>Description:</b> A smaller kelvin test pin which is designed to fit into a standard round hole, this to enable closer positioning and with suitable adhesive absolutely no pin rotation in use.	
Unless Otherwise Stated: Linear Tol.: $\pm 0.2$ , Angular Tol.: $0^{\circ}15'$ Surface Finish: $0.8\mu m$ All Dimensions: mm		Document Type: <b>PDF</b>		Drawn by: <b>G.D</b>	Drawn Date: <b>21.02.24</b>
Drawing Scale: <b>5:1</b>		<b>Company Confidential</b>		Checked/Approved by: <b>H.D</b>	Checked/Approved Date: <b>21.02.24</b>
Approx Weight: <b>0.15g</b>	Drawing Produced In Accordance With: <b>BS8888</b>		Legal Owner: 		Part Number: <b>KWP100F</b>
Projection Method: <b>THIRD ANGLE</b> 		Sheet Size: <b>A4</b>		Drawing Number: <b>1</b>	Sheet: <b>1 of 1</b>
		Oak Road, Little Maplestead, Halstead, Essex. CO9 2RT Telephone: 00 44 (0)1787478678 Registered No. 1470428		Revision: <b>A</b>	