



# SD-MINI-2PC

Spring loaded Interface array, with PCB & connector



# Test Probes & Interfacing Components

Telephone: +44 (0)1787 478678 | sales@coda-systems.co.uk | technical@coda-systems.co.uk | Fax: +44 (0)1787 274194

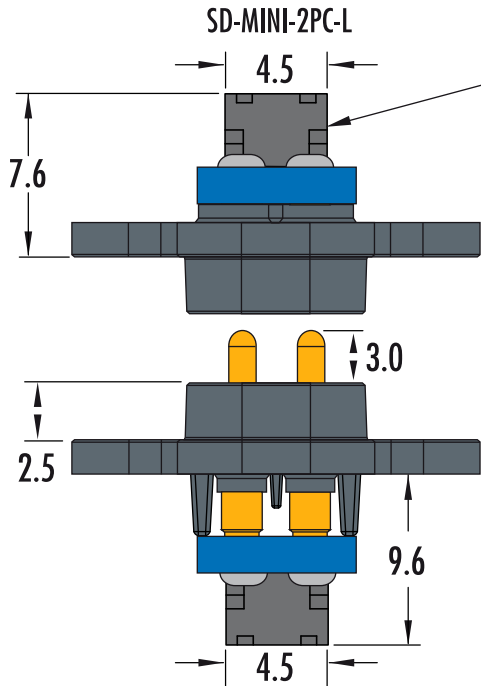

SD-MINI-2PC-L  
SD-MINI-2PC-SC  
Top view

CONNECTOR TYPE	JST: S2B-ZR
REQUIRED PLUG	JST: ZHR2

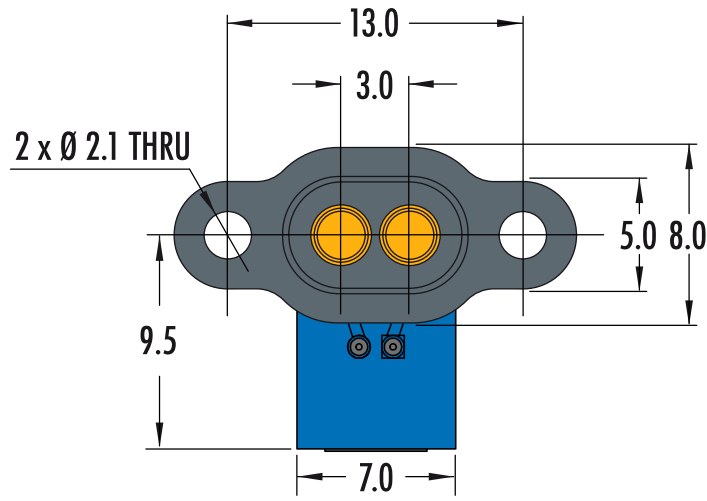

Land front view

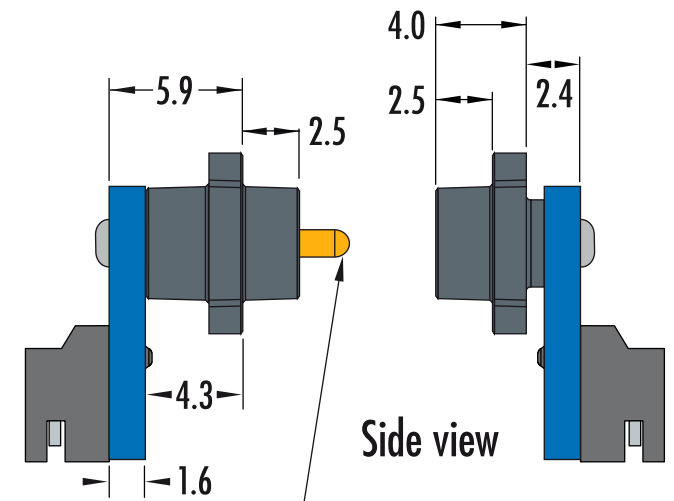

Side view

SPRING FORCE AT 1.3mm TRAVEL	100g
COMBINED SPRING FORCE (x2)	200g

Spring contact: PD14JST-SP  
Contact land: IPPS2S

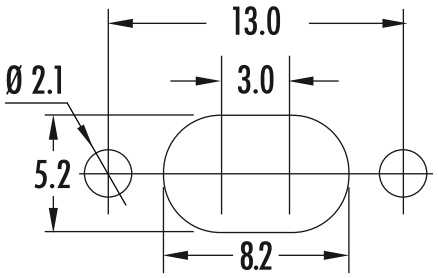

Panel cut-out dimensions

PART NUMBER		<b>SD-MINI-2PC-L SD-MINI-2PC-SC</b>		REGISTERED COMMUNITY DESIGN REGISTRATION NUMBER 002 124 362-0001		THE INFORMATION CONTAINED IN THIS DRAWING IS THE PROPERTY OF © CODA SYSTEMS LTD. NOT TO BE COPIED OR DISCLOSED TO A THIRD PARTY WITHOUT THE PRIOR, WRITTEN CONSENT OF CODA SYSTEMS LTD.	
SIZE	SCALE	PLASTIC TYPE		TOLERANCES		UNLESS OTHERWISE SPECIFIED 1. DIMENSIONS ARE IN MM 2. DIMENSIONAL LIMITS APPLY AFTER PLATING / COATING 3. REMOVE ALL BURRS AND BREAK EDGES .25 MAX 4. MACHINE FILLET RADIUS .25 MAX 5. MACHINED SURFACES FLAT WITHIN 0.08 mm/mm 6. NON-MACHINED SURFACES FLAT WITHIN 0.25 mm/mm 7. DIAMETERS ON COMMON CL TO BE CONCENTRIC WITHIN 0.13 8. PERPENDICULAR SURFACES TO BE SQUARE WITHIN .13 mm/mm 9. REFERENCE ( ) DIMENSIONS HAVE NO TOLERANCES	
<b>A4</b>	<b>3:1</b>	<b>POLYAMIDE PA66</b>		LINEAR .x = ±0.2mm .xx = ±0.10mm .xxx = ±0.025mm SURFACE ANGULAR ±1°			
<b>RoHS Compliant?</b> <input checked="" type="checkbox"/>				DRAWN IN ACCORDANCE WITH ANSI STANDARDS			
ENGINEER	VERSION	CHECKED BY	DATE				
<b>K. PERRY</b>	<b>D2</b>	<b>H. DAVIS</b>	<b>05/04/19</b>				