



SWIFT-DOCK-2P
Spring loaded interface
array, PCB, hard wire



**Test Probes &
Interfacing Components**

Telephone: +44 (0)1787 478678 | sales@coda-systems.co.uk | technical@coda-systems.co.uk | Fax: +44 (0)1787 274194

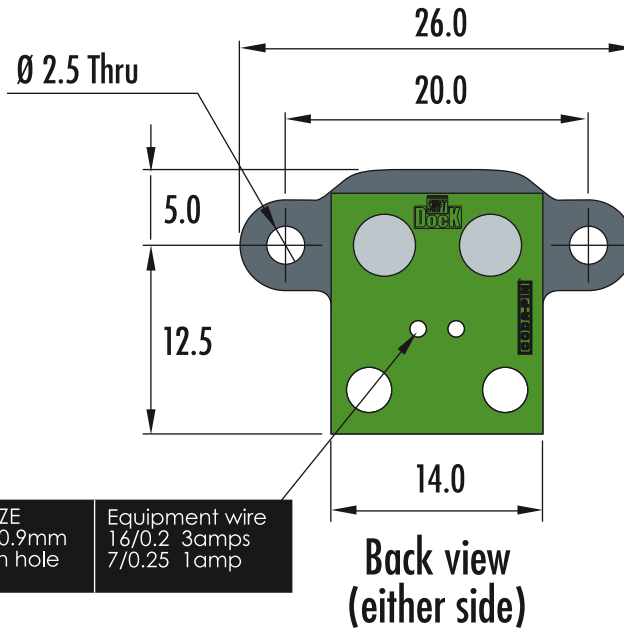
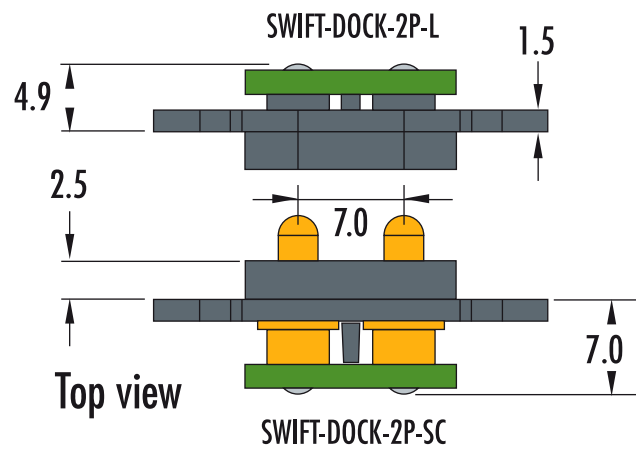

| | |
|---|---|
| WIRE SIZE (MAX) 0.9mm through hole | Equipment wire 16/0.2 3amps 7/0.25 1amp |
|---|---|

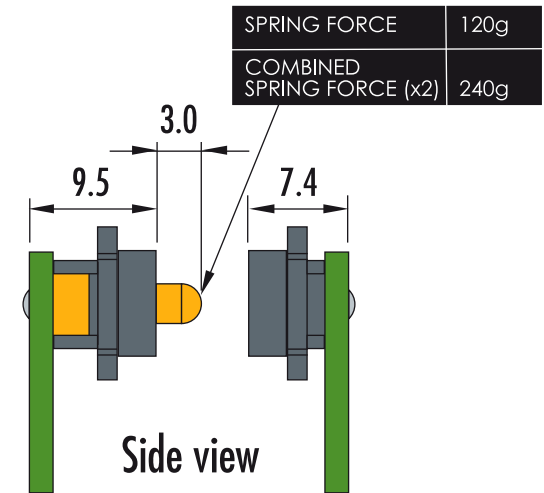

| | |
|-----------------------------------|------|
| SPRING FORCE | 120g |
| COMBINED SPRING FORCE (x2) | 240g |

Spring contact: PD11JST-SP
Contact land: IPP2S
Ideal compression PD11: 2mm

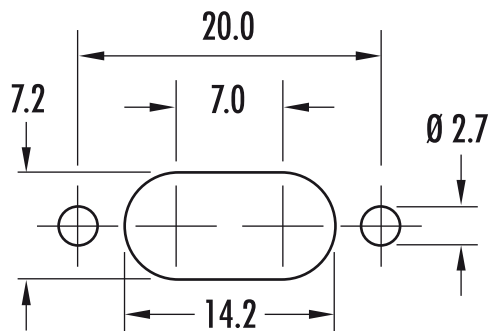

| | | | | |
|--|-------------------------------|---|---|---|
| PART NUMBER SWIFT-DOCK-2P-L & SWIFT-DOCK-2P-SC | | REGISTERED COMMUNITY DESIGN REGISTRATION NUMBER 002 124 362-0001 | THE INFORMATION CONTAINED IN THIS DRAWING IS THE PROPERTY OF © CODA SYSTEMS LTD. NOT TO BE COPIED OR DISCLOSED TO A THIRD PARTY WITHOUT THE PRIOR, WRITTEN CONSENT OF CODA SYSTEMS LTD. | |
| SIZE A4 | SCALE 2:1 | PLASTIC TYPE POLYAMIDE PA66 | VERSION D3 | TOLERANCES .x = ± 0.2mm .xx = ± 0.10mm .xxx = ± 0.025mm SURFACE ANGULAR ± 1° |
| RoHS Compliant? <input checked="" type="checkbox"/> | | | UNLESS OTHERWISE SPECIFIED 1. DIMENSIONS ARE IN MM 2. DIMENSIONAL LIMITS APPLY AFTER PLATING / COATING 3. REMOVE ALL BURRS AND BREAK EDGES .25 MAX 4. MACHINE FILLET RADIUS .25 MAX 5. MACHINED SURFACES FLAT WITHIN 0.08 mm/mm 6. NON-MACHINED SURFACES FLAT WITHIN 0.25 mm/mm 7. DIAMETERS ON COMMON CL TO BE CONCENTRIC WITHIN 0.13 8. PERPENDICULAR SURFACES TO BE SQUARE WITHIN .13 mm/mm 9. REFERENCE () DIMENSIONS HAVE NO TOLERANCES | |
| ENGINEER K. PERRY | CHECKED BY H. DAVIS | DATE 05/04/19 | | DRAWN IN ACCORDANCE WITH ISO STANDARDS |