

Contact land, press fitment

IPPS2SS



Test Probes & Interfacing Components

Telephone: +44 (0)1787 478678

sales@coda-systems.co.uk

technical@coda-systems.co.uk

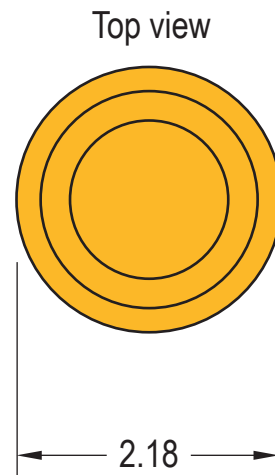
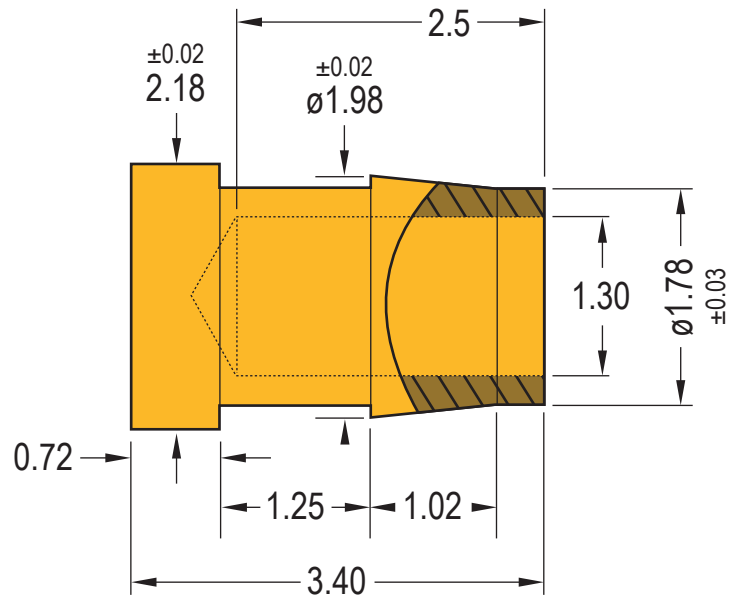

Specifications	
Material	Brass CZ121
Plating	0.25-0.5 μ m Au over 3-5 μ m Nickel
Installation	<ul style="list-style-type: none"> • Press fitment or over moulding • Solder pot (no solder in termination) • Drill hole size; 1.90mm • Panel thickness; 2.3mm

PART NUMBER IPPS2SS		THE INFORMATION CONTAINED IN THIS DRAWING IS THE PROPERTY OF © CODA SYSTEMS LTD. NOT TO BE COPIED OR DISCLOSED TO A THIRD PARTY WITHOUT THE PRIOR, WRITTEN CONSENT OF CODA SYSTEMS LTD.	
SIZE A4	SCALE NTS	DRAWN IN ACCORDANCE WITH ISO STANDARDS	UNLESS OTHERWISE SPECIFIED 1. DIMENSIONS ARE IN MM 2. DIMENSIONAL LIMITS APPLY AFTER PLATING / COATING 3. REMOVE ALL BURRS AND BREAK EDGES .25 MAX 4. MACHINE FILLET RADIUS .25 MAX 5. MACHINED SURFACES FLAT WITHING 0.08 mm/mm 6. NON-MACHINED SURFACES FLAT WITHIN 0.25 mm/mm 7. DIAMETERS ON COMMON CL TO BE CONCENTRIC WITHIN 0.13 8. PERPENDICULAR SURFACES TO BE SQUARE WITHIN .13 mm/mm 9. REFERENCE () DIMENSIONS HAVE NO TOLERANCES
RoHS Compliant?		DATE 01/04/20	
<input checked="" type="checkbox"/>		VERSION D1	